

STATEK CORPORATION						
STATEK CORPORATION Model Number	Andon Part Number Replace "XXX" with Terminal Type	Terminal Type		Pin Ø [in]	Figure Number	Page Number
		Thru-Hole	Surface Mount			
LXO	C10-314-04-01-XXX-R27-L14	01S	93S	.018	1	1
LXO1	C10-314-04-01-XXX-R27-L14	01S	93S	.018	1	1
LXO-AT	C10-314-04-01-XXX-R27-L14	01S	93S	.018	1	1
LXOM	C10-308-04-02-XXX-R27-L14	01S	93S	.018	2	1
LXOM-AT	C10-308-04-02-XXX-R27-L14	01S	93S	.018	2	1
SQXO-2	R200-0403-03T-XXX-R27-L14	01S	93S	.018	3	1
DQXO-3	R200-0403-03T-XXX-R27-L14	01S	93S	.018	3	1
LQXO-4	R200-0403-03T-XXX-R27-L14	01S	93S	.018	3	1
LHGAT	C20-002-02-02-XXX-R27-L14	01S	93S	.018	4	1
LHTAT	C20-002-02-02-XXX-R27-L14	01S	93S	.018	4	1
SQXO2ATSM	620-24B-SM-G10-L14-1	-	-	-	5	2
SQXO2SM	620-24B-SM-G10-L14-1	-	-	-	5	2
DQXO3SM	620-24B-SM-G10-L14-1	-	-	-	5	2
VCXO	605D-06A-SM-G10-L14-1	-	-	-	6	2

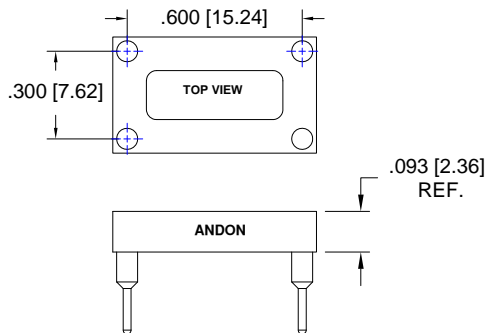

**Fig. 01**

Thru-Hole: C10-314-04-01-01S-R27-L14  
Surface Mount: C10-314-04-01-93S-R27-L14

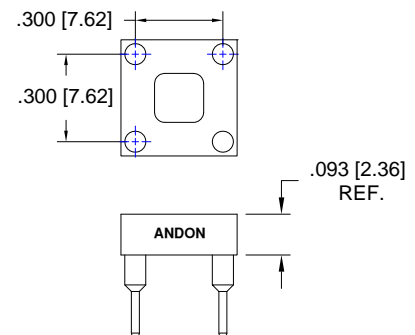

**Fig. 02**

Thru-Hole: C10-308-04-02-01S-R27-L14  
Surface Mount: C10-308-04-02-93S-R27-L14

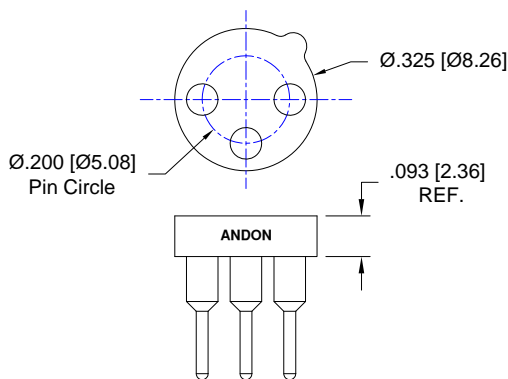

**Fig. 03**

Thru-Hole: R200-0403-03T-01S-R27-L14  
Surface Mount: R200-0403-03T-93S-R27-L14

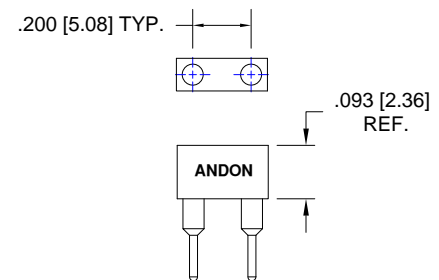

**Fig. 04**

Thru-Hole: C20-002-02-02-01S-R27-L14  
Surface Mount: C20-002-02-02-93S-R27-L14

**Statek Corporation Continued**

**Top View Shown**

Units: in [mm]

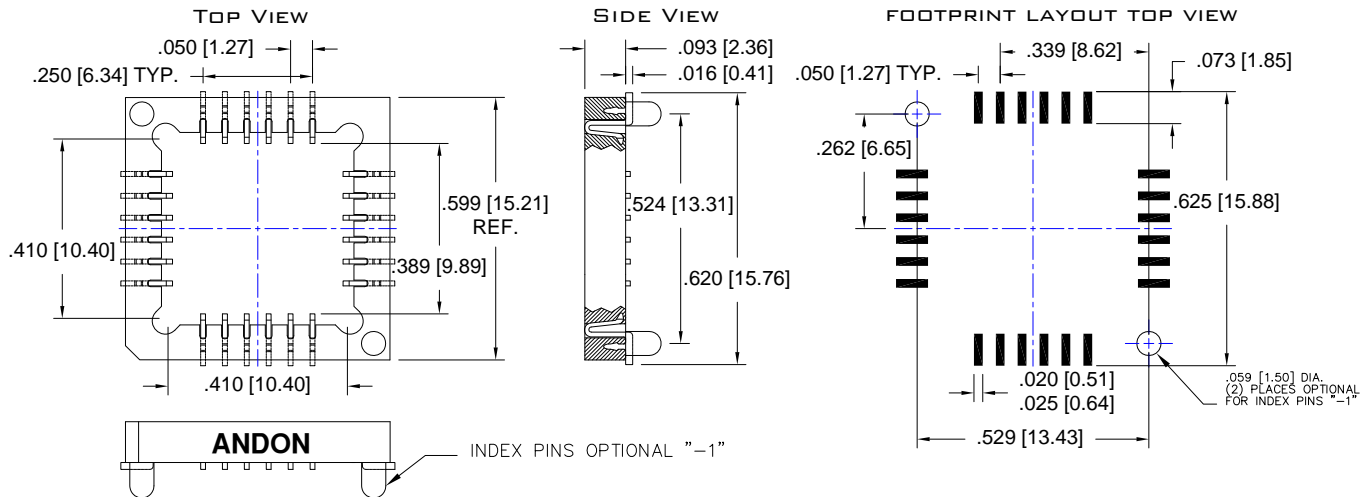
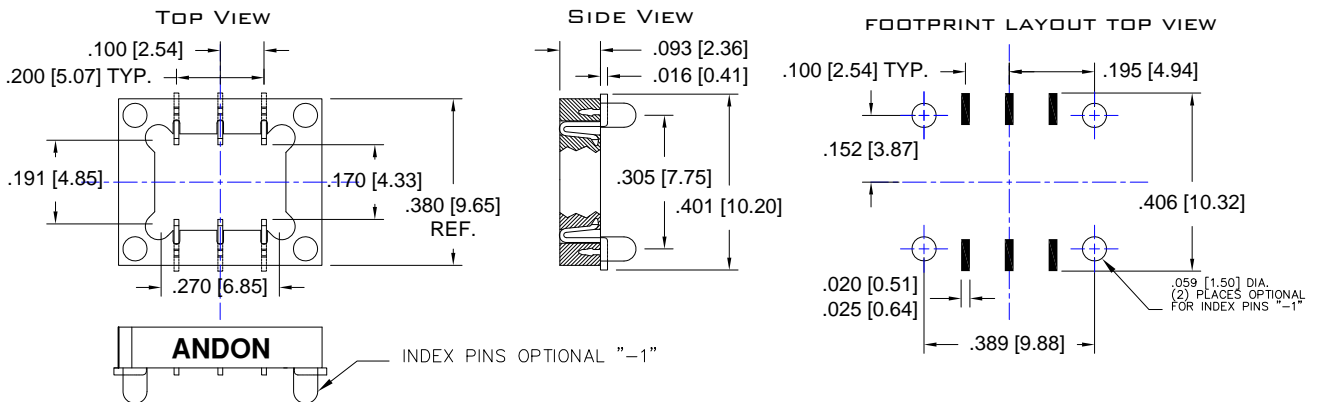

**Fig. 05**

Thru-Hole: N/A

Surface Mount: 620-24B-SM-G10-L14-X

Replace "-X" with "-1" for index pins or "-0" for none



**Fig. 06**

Thru-Hole: N/A

Surface Mount: 605D-06A-SM-G10-L14-X

Replace "-X" with "-1" for index pins or "-0" for none

## Statek Corporation Continued Socket Terminal Details Cross Section View Shown Units: in [mm]

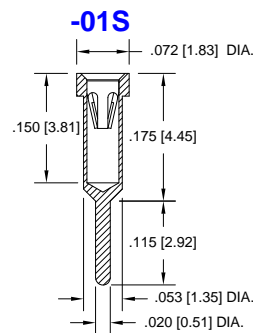
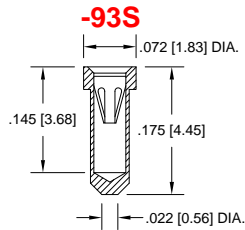

### Technical Information

**Material:**

Insulator: Hi-Temp UL 94V-O  
Terminal: Brass, per ASTM-B16  
Contact: BeCu, Per ASTM-B194

**Plating: RoHS COMPLIANT**

R15 TERMINAL: GOLD / CONTACT: GOLD

R17 TERMINAL: TIN / CONTACT: GOLD

OTHER PLATINGS AVAILABLE

Terminal Acceptance and Forces							
Thru Hole Terminals				Surface Mount Terminals			
Thru Hole Terminal	Accepts Pin Diameter	Insertion Force	Withdrawal Force	Surface Mount Terminal	Accepts Pin Diameter	Insertion Force	Withdrawal Force
-01S	Ø.018 [Ø0.46]	9.0 oz Avg.	2.0 oz Min	-93S	Ø.018 [Ø0.46]	9.0 oz Avg.	2.0 oz Min

