

SUNNY ELECTRONICS CORP. USA						
SUNNY ELECTRONICS CORP. USA Model Number	Andon Part Number Replace "XXX" with Terminal Type	Terminal Type		Pin Ø [in]	Figure Number	Page Number
		Thru-Hole	Surface Mount			
SCO-06	C10-308-04-02-XXX-R27-L14	01S	93S	.018	5	2
.SVA (HALF)	C10-308-04-02-XXX-R27-L14	01S	93S	.018	5	2
SPO-02	C10-614-05-01-XXX-R27-L14	01S	93S	.018	4	2
SCO-02	C10-614-05-01-XXX-R27-L14	01S	93S	.018	4	2
SVA (FULL)	C10-614-05-01-XXX-R27-L14	01S	93S	.018	4	2
SVB	C10-614-05-01-XXX-R27-L14	01S	93S	.018	4	2
SPV-02	C10-614-05-01-XXX-R27-L14	01S	93S	.018	4	2
SLV-02	C10-614-05-01-XXX-R27-L14	01S	93S	.018	4	2
SVC	C10-614-05-01-XXX-R27-L14	01S	93S	.018	4	2
UM-1	CSP148-02-03-XXX-R27-L14	C2	N/A	.018	2	1
UM-5	CSP148-02-03-XXX-R27-L14	C2	N/A	.018	2	1
ATS-25/U	CSP192-02-01-XXX-R27-L14	01S	93S	.018	3	1
ATS-49/U	CSP192-02-01-XXX-R27-L14	01S	93S	.018	3	1
ATS-SI/U	CSP192-02-01-XXX-R27-L14	01S	93S	.018	3	1
HC-49/U	CSP192-02-01-XXX-R27-L14	01S	93S	.018	3	1
HC-49/T	CSP192-02-01-XXX-R27-L14	01S	93S	.018	3	1
CH-308	C031-002-02-01-XXX-R27-L14	437T	329T	.012	1	1
SCO-10	606D-04A-SM-G10-L14-1	-	-	-	6	2
SPV-10	605D-06B-SM-G10-L14-1	-	-	-	7	2
SLV-10	605D-06B-SM-G10-L14-1	-	-	-	7	2
SPO-10	605D-06B-SM-G10-L14-1	-	-	-	7	2
SLO-10	605D-06B-SM-G10-L14-1	-	-	-	7	2
SHO-10	605D-06B-SM-G10-L14-1	-	-	-	7	2

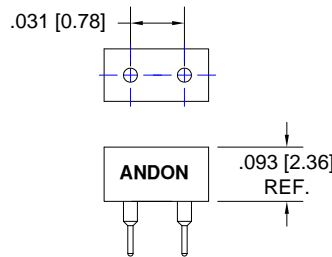

**Fig. 1**

Thru-Hole: C031-002-02-01-**437T**-R27-L14  
Surface Mount: C031-002-02-01-**329T**-R27-L14

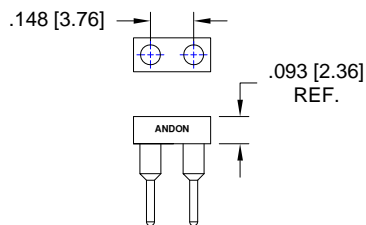

**Fig. 2**

Thru-Hole: CSP148-02-03-**C2**-R27-L14  
Surface Mount: CSP148-02-03-**N/A**-R27-L14

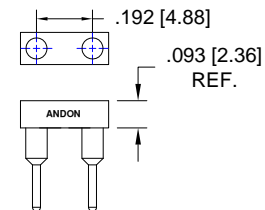
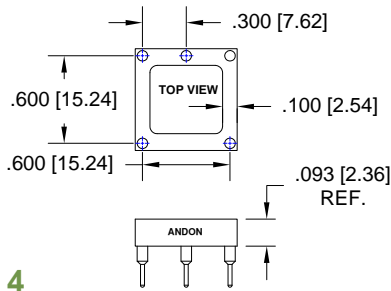

**Fig. 3**

Thru-Hole: CSP192-02-01-**01S**-R27-L14  
Surface Mount: CSP192-02-01-**93S**-R27-L14

**SUNNY ELECTRONICS CORP. USA Continued**

**Socket Terminal Details**  
Cross Section View Shown Units: in [mm]



**Fig. 4**

Thru-Hole: C10-614-05-01-01S-R27-L14  
Surface Mount: C10-614-05-01-93S-R27-L14

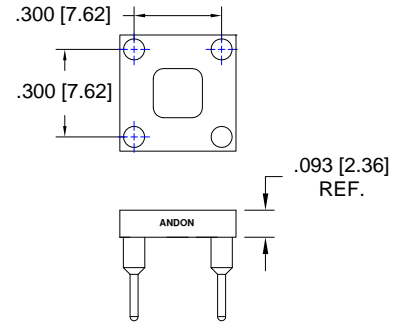

**Fig. 5**

Thru-Hole: C10-308-04-02-01S-R27-L14  
Surface Mount: C10-308-04-02-93S-R27-L14

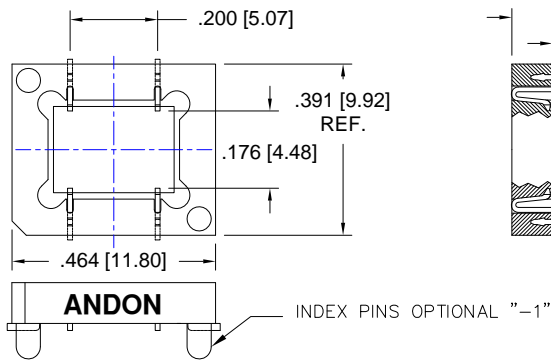

**Fig. 6**

Thru-Hole: N/A  
Surface Mount: 606D-04A-SM-G10-L14-X

WITHOUT INDEX PINS = -0  
WITH INDEX PINS = -1

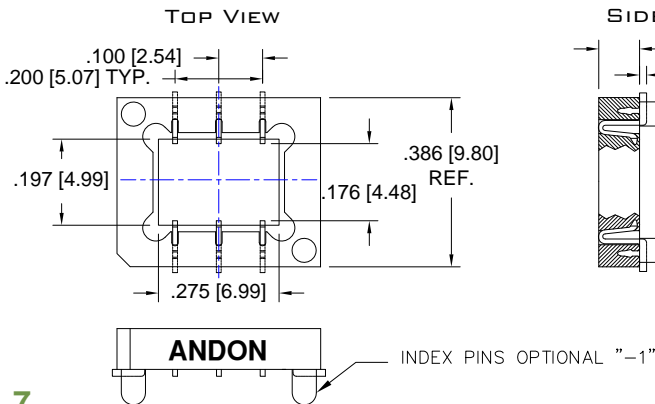
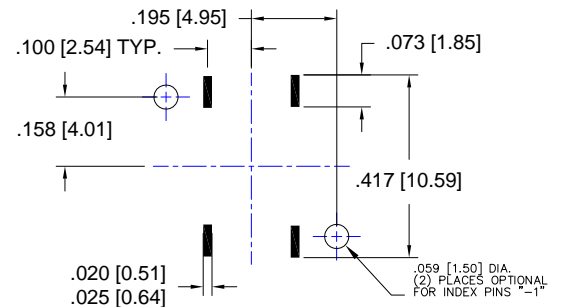
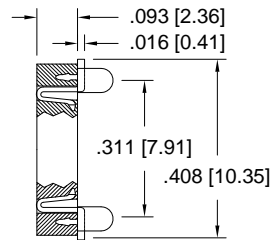

**Fig. 7**

Thru-Hole: N/A  
Surface Mount: 605D-06B-SM-G10-L14-X

WITHOUT INDEX PINS = -0  
WITH INDEX PINS = -1

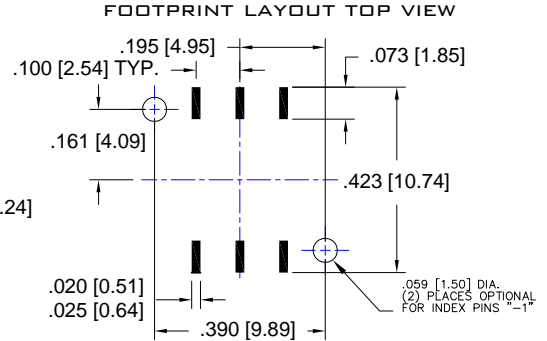
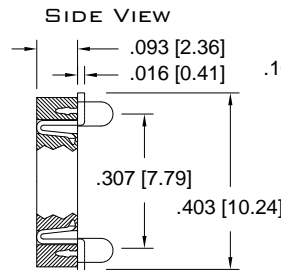

## SUNNY ELECTRONICS CORP. USA *Continued*

### Socket Terminal Details Cross Section View Shown Units: in [mm]

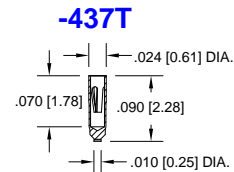
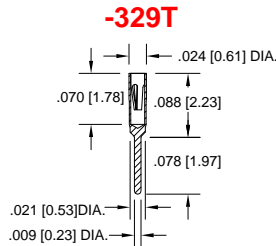
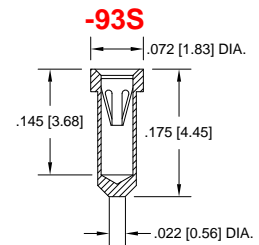
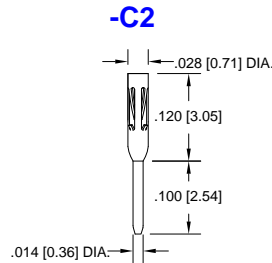
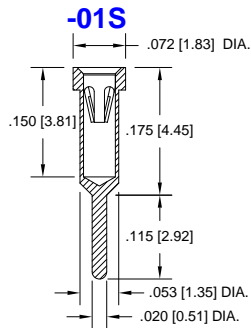

## Technical Information

### Material:

Insulator: Hi-Temp UL 94V-O  
Terminal: Brass, per ASTM-B16  
Contact: BeCu, Per ASTM-B194

### Plating: RoHS COMPLIANT

R15 TERMINAL: GOLD / CONTACT: GOLD

R17 TERMINAL: TIN / CONTACT: GOLD

OTHER PLATINGS AVAILABLE

### Terminal Acceptance and Forces

Thru Hole Terminals				Surface Mount Terminals			
Thru Hole Terminal	Accepts Pin Diameter	Insertion Force	Withdrawal Force	Surface Mount Terminal	Accepts Pin Diameter	Insertion Force	Withdrawal Force
-01S	Ø.018 [Ø0.46]	9.0 oz Avg.	2.0 oz Min	-93S	Ø.018 [Ø0.46]	9.0 oz Avg.	2.0 oz Min
-C2	Ø.018 [Ø0.46]	1.5 oz Max	0.04 oz Min	-329T	Ø.010 [Ø0.25]	1.0 oz Max	0.3 oz Min
-437T	Ø.010 [Ø0.25]	1.0 oz Max	0.3 oz Min				

### MOUNTING OPTIONS

